

PLOT N°	PLOT AREA (m <sup>2</sup> )
16	1.119

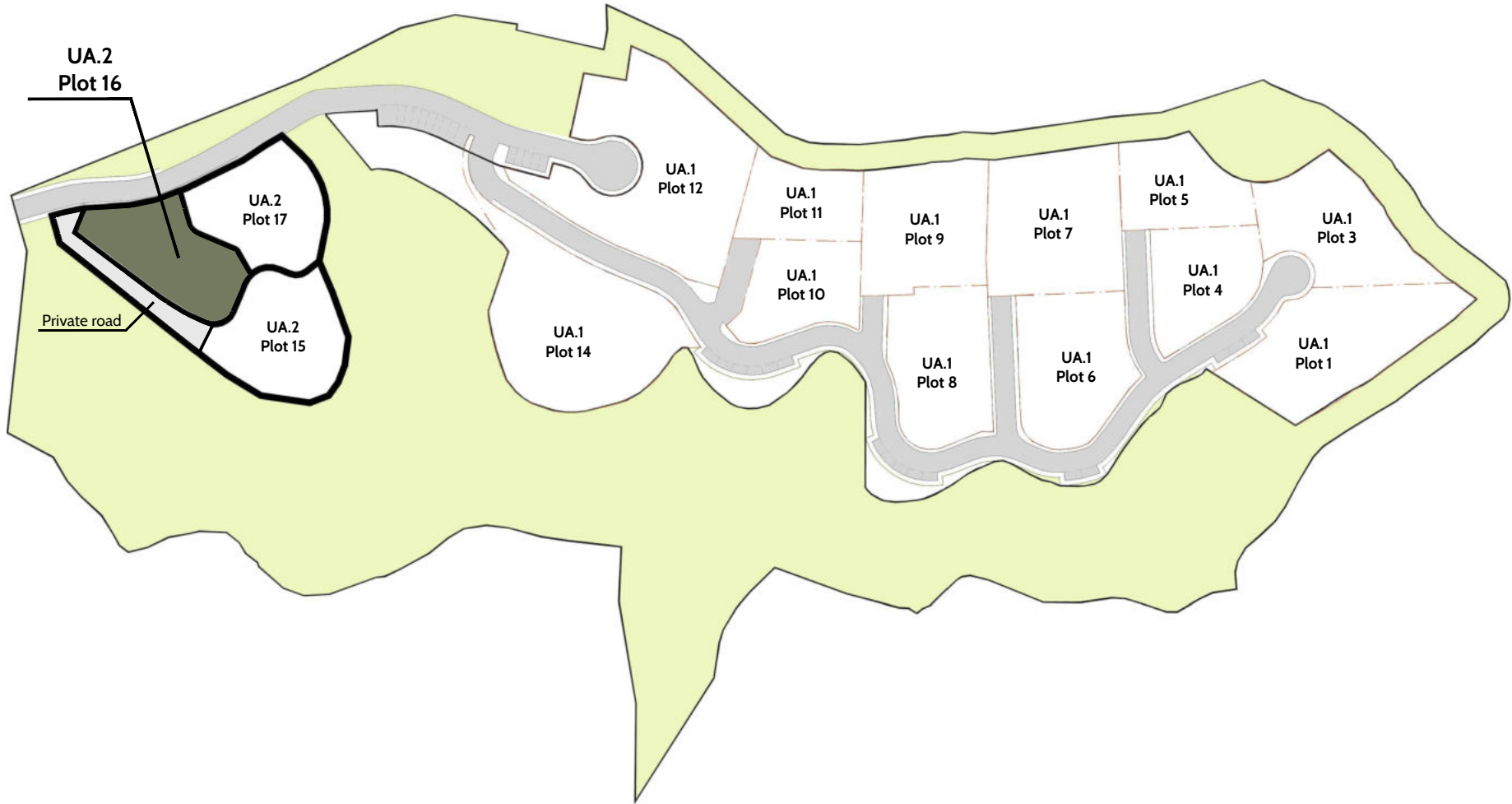

-1 LEVEL	
Built area	280,45 m <sup>2</sup>
Porch	0,00 m <sup>2</sup>
Terraces	26,90 m <sup>2</sup>
Garage	41,00 m <sup>2</sup>

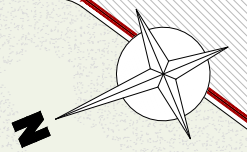

0 LEVEL	
Built area	191,25 m <sup>2</sup>
Porch	33,30 m <sup>2</sup>
Terraces	269,70 m <sup>2</sup>
Garage	50,95 m <sup>2</sup>

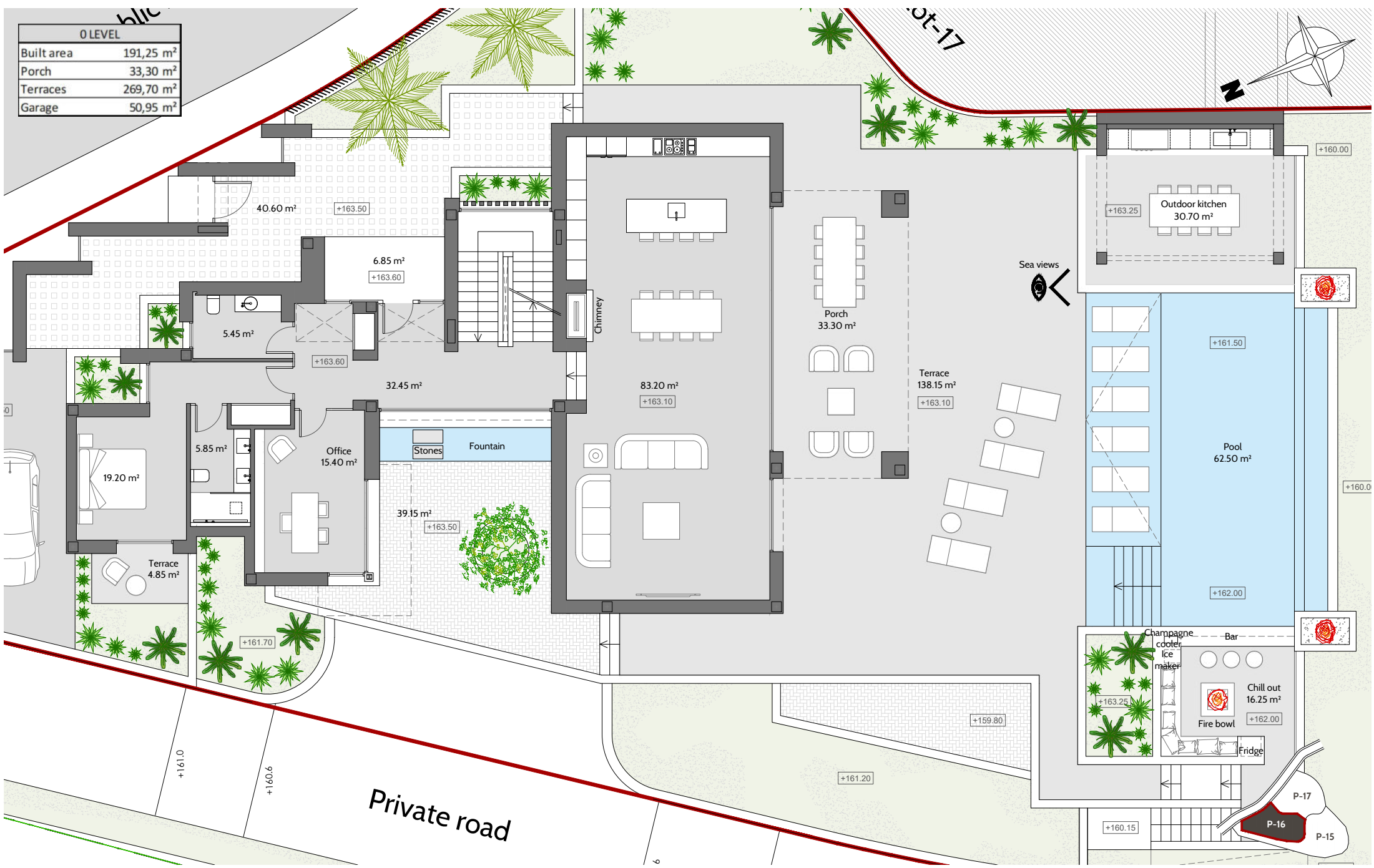

Total built area:	615,50 m <sup>2</sup>
Porch:	33,30 m <sup>2</sup>
Plot:	1.119,00 m <sup>2</sup>
Bedrooms:	5
Bathrooms:	5
Guest toilet:	3
Views:	Sea & mountain
Terraces:	369,10 m <sup>2</sup>
Garage:	91,95 m <sup>2</sup>

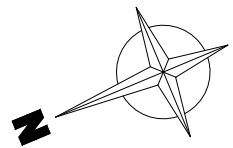

+1 LEVEL	
Built area	143,80 m <sup>2</sup>
Porch	0,00 m <sup>2</sup>
Terraces	72,50 m <sup>2</sup>

Public road

Plot-17

